

Data Sheet

Itemnumber....: 3243154109

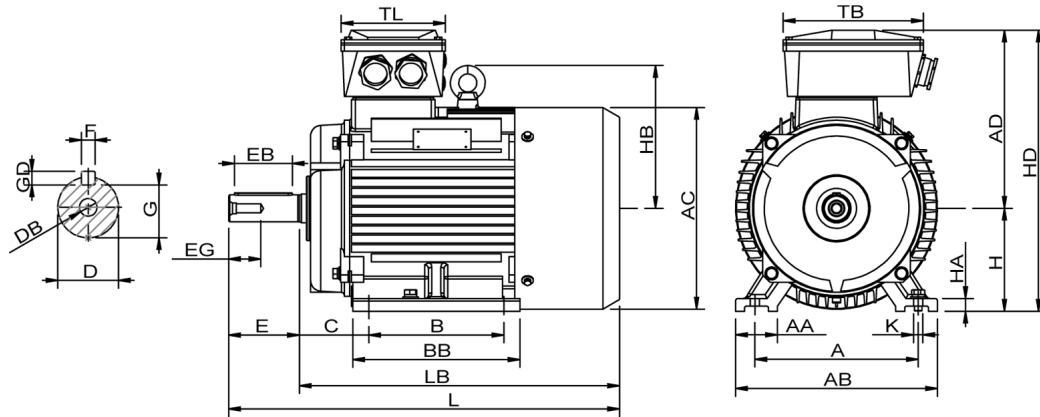

A = 508	AC = 620	BB = 680	DB = M20	EG = 56	GD = 14	HB = 442	L = 1458	TL = 280
AA = 120	AD = 556	C = 216	E = 170	F = 22	H = 315	HD = 871	LB = 1288	
AB = 628	B = 508	D = 80	EB = 140	G = 71	HA = 45	K = 28	TB = 400	

Version

Type.....: HMC2 315L3-4
 Design.....: Induction motor
 Standard series.....: IEC 60034
 Phase / Voltage range.....: 3~ / Low

Electrical design

Efficiency.....: IE2
 Pole.....: 4
 Power at 50 Hz (kW).....: 250
 Hz.....: 60 (60 Hz output)
 Voltage.....: 440VD
 Winding voltage.....: 400VD/690VY 50 Hz
 Power output (kW).....: 290
 Duty.....: S1
 Insulation class.....: F
 Temperature rise.....: F

Motor protection

Thermal protection main....: PTC 3x 155 dgr
 Thermal protection second..: None
 Space heater.....: 1x 230V 100W
 Temperature detector.....: No
 SPM.....: No
 IR wire.....: No
 Tropical insulation.....: Yes

Explosion protection

According to.....: None
 Type of protection.....: None

General

Direction of rotation.....: CW
 Painting.....: RAL 9005
 Nameplate.....: Multivoltage + VFD
 Special packing.....: No
 Special requirements.....: No

Mechanical design

Frame size.....: 315
 Mounting.....: B3
 Rain cap.....: No
 Protection class.....: IP55
 Cooling method.....: IC411/TEFC
 External grounding.....: Yes
 Drain hole.....: Yes
 Frame material.....: Cast Iron
 Material approval.....: None
 Shaft.....: IEC Standard
 Key.....: Closed key
 Balancing.....: Half key balancing
 Vibration class.....: Grade-A
 Weight (kg).....: 1.460

Environment condition

Ambient temp. min. (°C)..: -20
 Ambient temp. max. (°C)..: 45
 Altitude (mtr up to).....: 1000

Bearing

DE Bearing.....: 6319/C3
 NDE Bearing.....: 6319/C3
 Fixed bearing.....: DE

Terminal box

Tbox position.....: Top
 Cable entry direction.....: Right (from DE)
 Cable entry
 Main.....: 2 x M63x1,5
 Ø37-44mm metal
 Accessory.....: 2 x M20x1,5
 Metal blindcaps
 Terminal board thread.....: 6-M16

Test values

Rotor inertia (kgm²).....: 6,55
 No load current (A).....: 124
 Winding resist. (ohm).....: 0,0078
 Starting time (sec.).....: 0,28

Rated power (kW)	250	242	300	290
Frequency (Hz)	50	50	60	60
Voltage (V)	400 690	380 660	480 830	440
Connection	D Y	D Y	D Y	D
Full load current (A)	420 244	435 250	420 244	440
Speed (rpm)	1490	1490	1790	1790
Power factor cos(phi)	0,90	0,91	0,90	0,91
Efficiency, 100/75/50 (%)	95,1/ 95,0 /94,4	95,1/ 95,0 /94,4	95,1/ 95,0 /94,4	94,8/ 94,6 /94,0
Ist/In	6,85	6,05	6,85	6,30
Full load torque (Nm)	1.600	1.560	1.600	1.560
Tst/Tn	2,42	2,24	2,42	2,10
Tmax/Tn	3,10	2,90	3,10	2,70
Duty	S1	S1	S1	S1
Ambient temp. (°C)	40	45	40	45